

Przepisy World Aquatics (FINA) dotyczą ce torów basenowych
Oryginalna wersja angielska w po niejszej cze ci pliku

18

ZAŁĄCZNIKI

- 18.1 ZAŁĄCZNIK 1 – SCHEMAT BASENU 50 x 25 m – 8 torów
- 18.2 ZAŁĄCZNIK 2 – SCHEMAT BASENU 50 X 25 m – 10 torów
- 18.3 ZAŁĄCZNIK 3 – SCHEMAT BASENU 50 X 25 m – 10 torów
- 18.4 ZAŁĄCZNIK 4 – SCHEMAT BASENU 50 X 25 Z JEDNĄ ŚCIANKĄ PRZEGRODOWĄ W POZYCJI BOCZNEJ
- 18.5 ZAŁĄCZNIK 5 – SCHEMAT BASENU 50 X 25 M Z JEDNĄ ŚCIANKĄ PRZEGRODOWĄ – ŚCIANKA PRZEGRODOWA W POZYCJI ŚRODKOWEJ
- 18.6 ZAŁĄCZNIK 6 – SCHEMAT BASENU 25 X 21 M – 8 TORÓW
- 18.7 ZAŁĄCZNIK 7 – SCHEMAT BASENU 25X21M – 8 TORÓW
- 18.8 ZAŁĄCZNIK 8 – SCHEMAT BASENU 25X25M – 10 torów
- 18.9 ZAŁĄCZNIK 9 – SCHEMAT BASENU 25X26 M – 10 torów
- 18.10 ZAŁĄCZNIK 10 – SCHEMAT BASENU 50 M – Oznaczenia torów

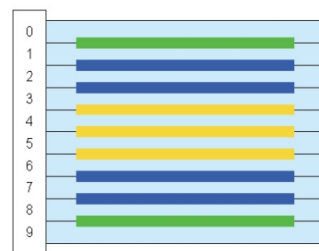
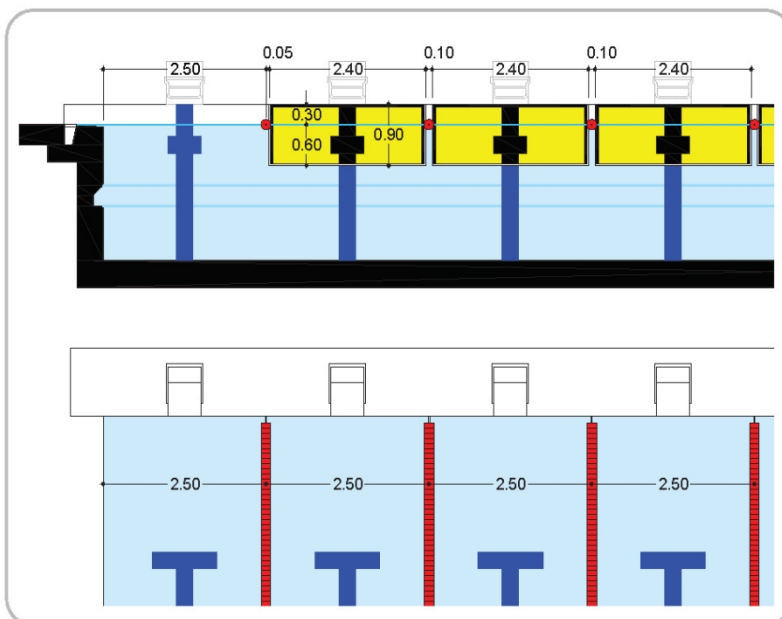
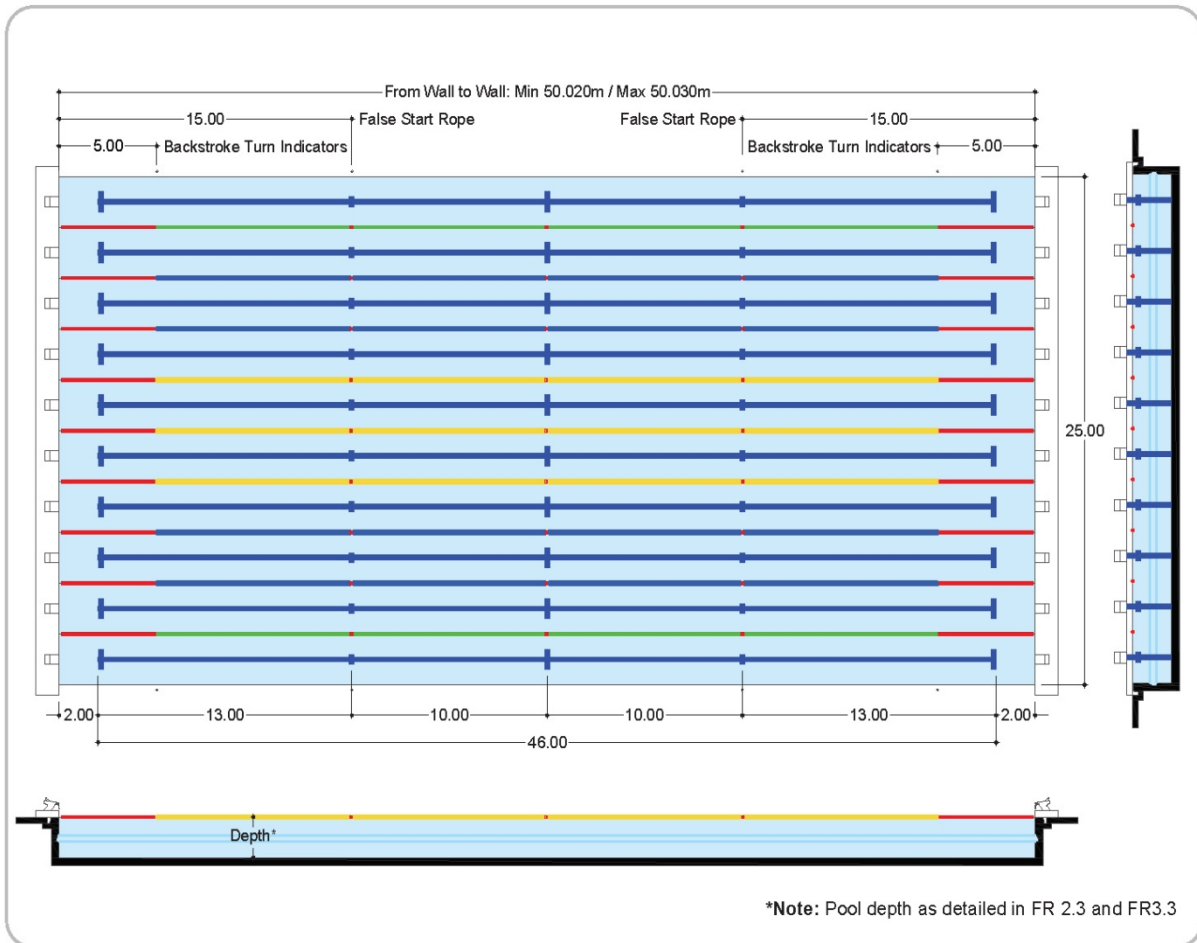

Lane Ropes

In a 8 (eight) lanes swimming pool the colour of the lane ropes should be as follows:

- Two (2) GREEN ropes for lanes 1 and 8.
- Four (4) BLUE ropes for lanes 2, 3, 6 and 7.
- Three (3) YELLOW ropes for lanes 4, 5.

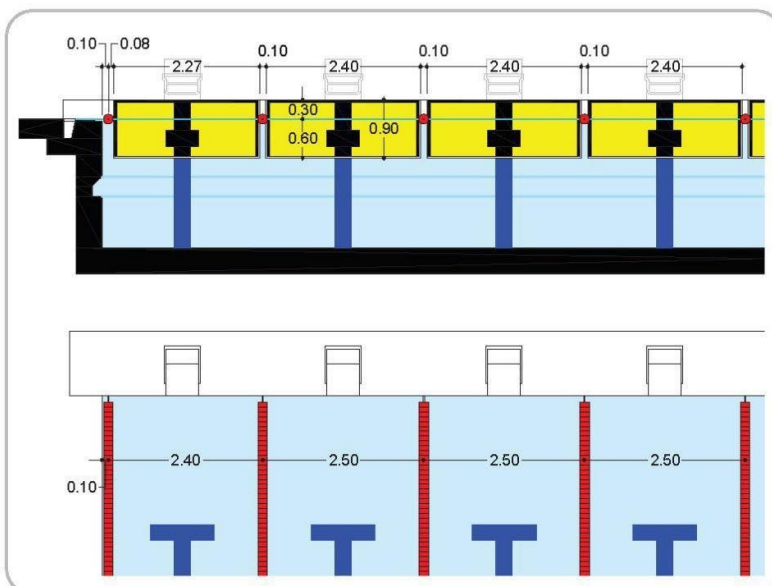
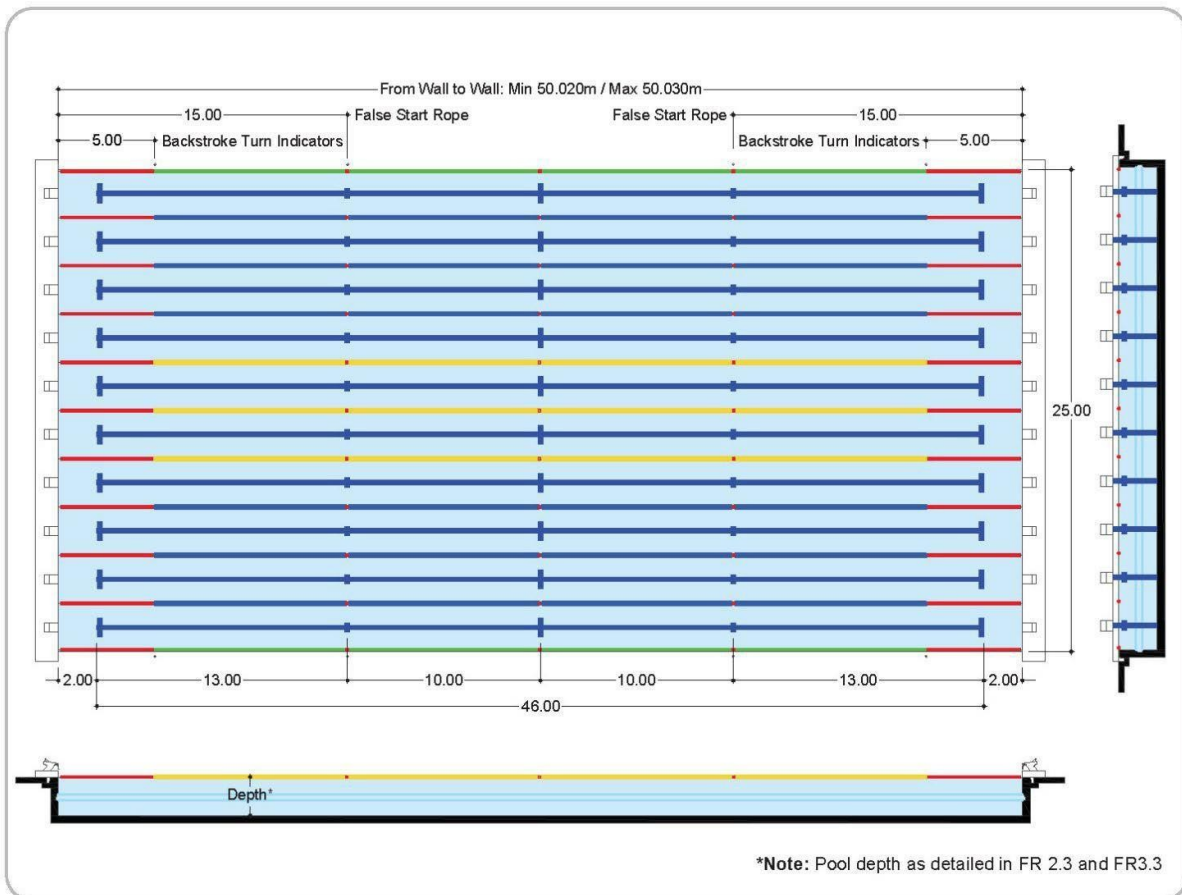
Lane Ropes

In a 10 (ten) lanes swimming pool the colour of the lane ropes should be as follows:

- Two (2) GREEN ropes for lanes 0 and 9.
- Six (6) BLUE ropes for lanes 1, 2, 3, 6, 7 and 8.
- Three (3) YELLOW ropes for lanes 4, 5.

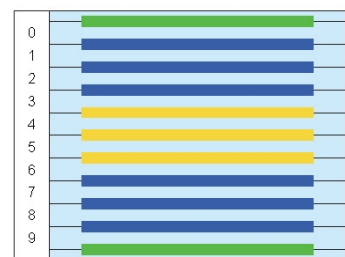
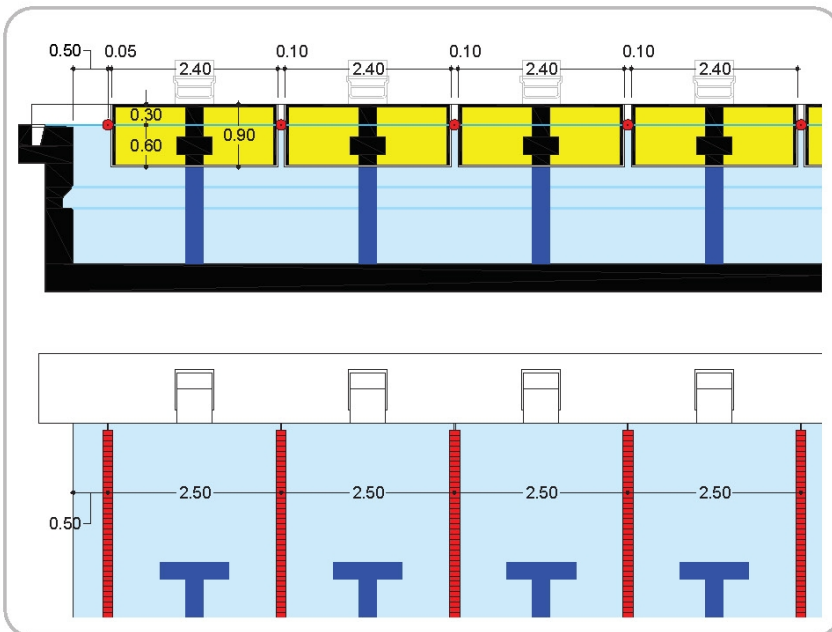
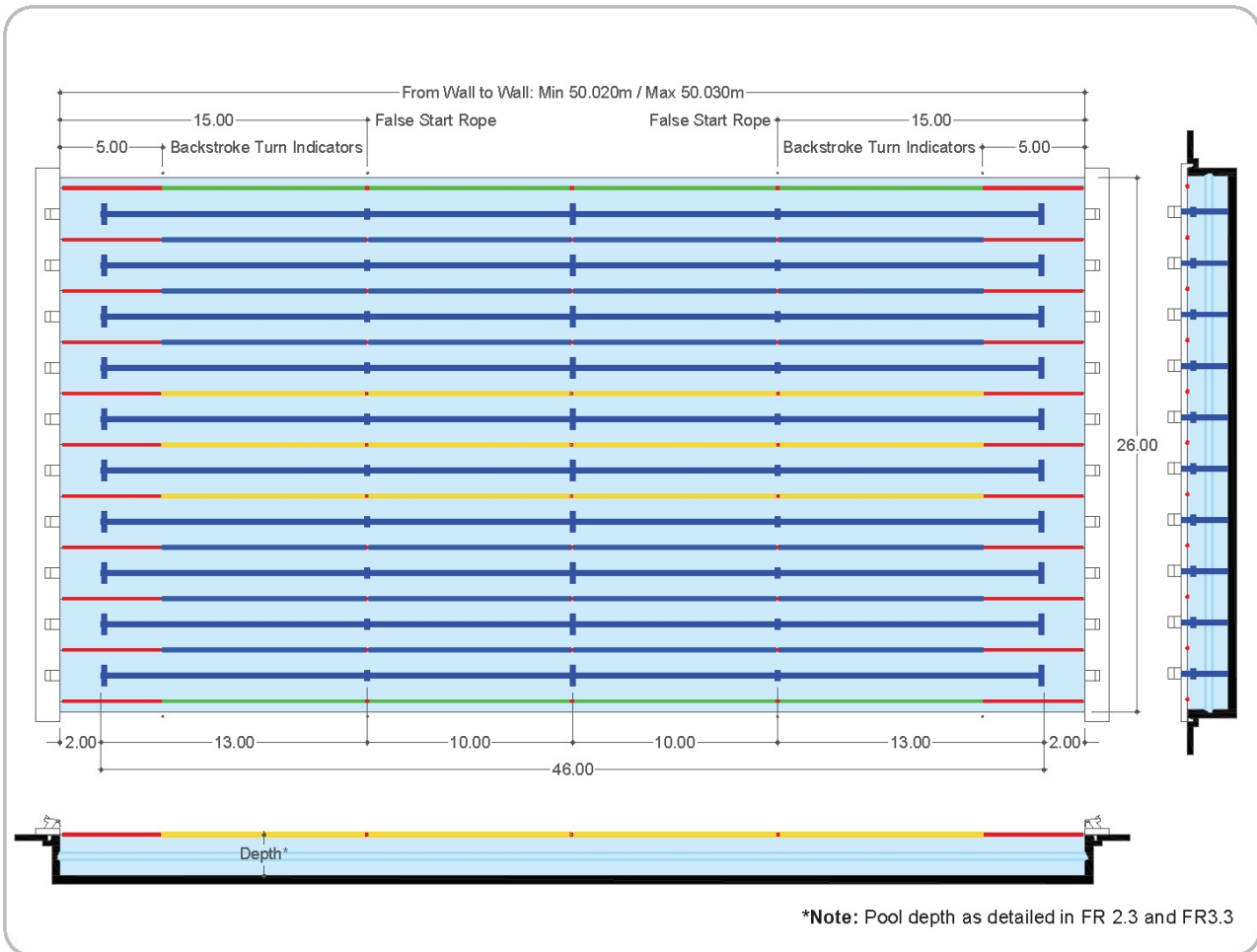

Lane Ropes

In a 10 (ten) lanes swimming pool the colour of the lane ropes should be as follows:

- Two (2) GREEN ropes for lanes 0 and 9.
- Six (6) BLUE ropes for lanes 1, 2, 3, 6, 7 and 8.
- Three (3) YELLOW ropes for lanes 4, 5.

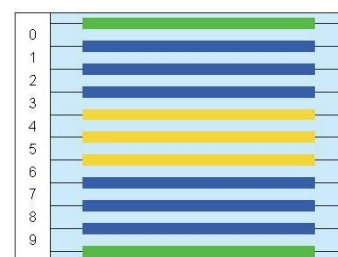
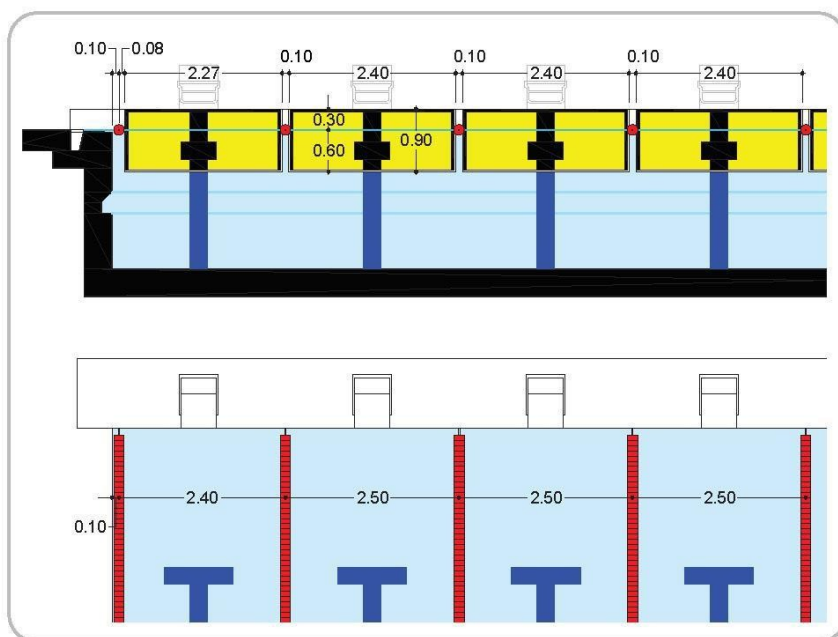
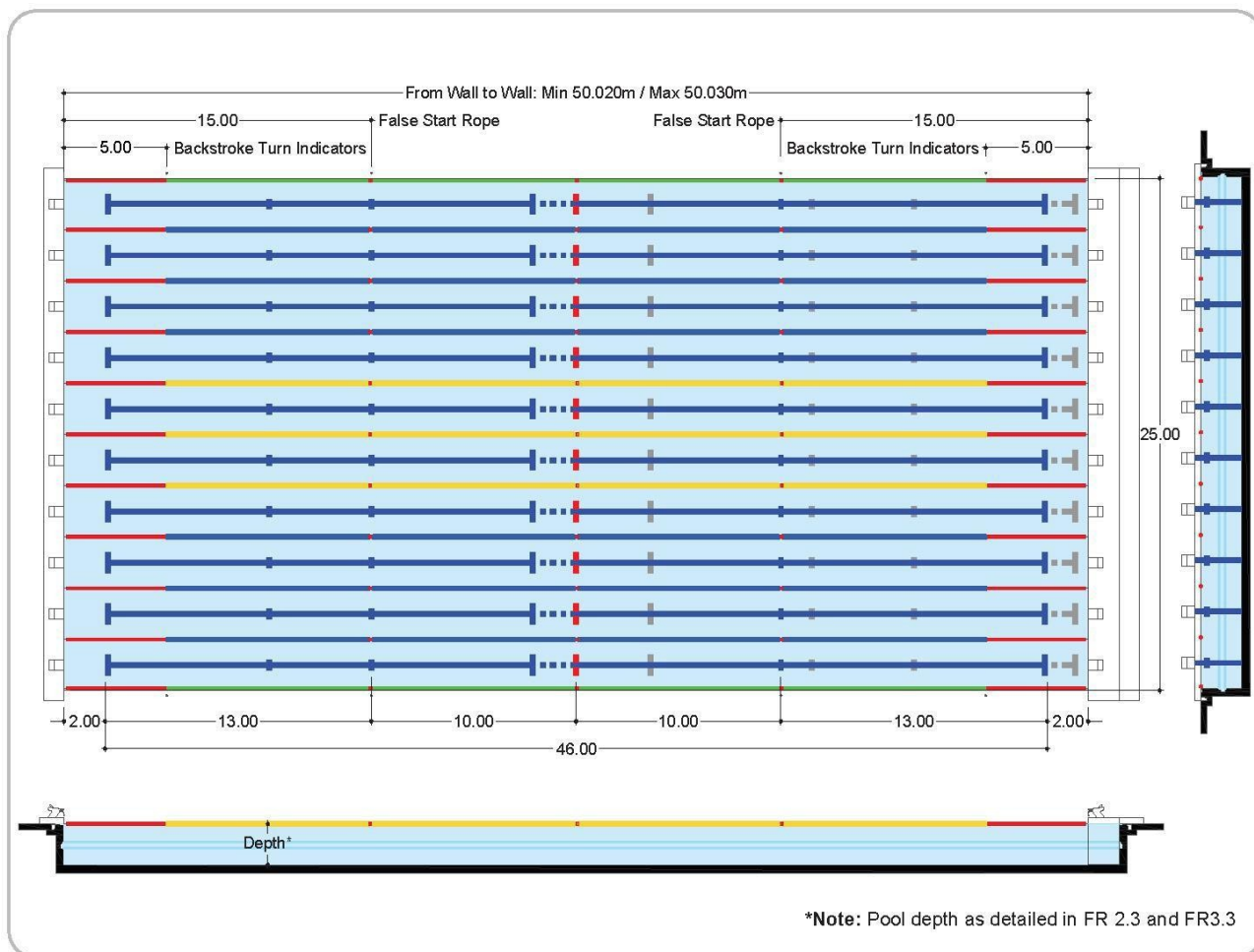

Lane Ropes

In a 10 (ten) lanes swimming pool the colour of the lane ropes should be as follows:

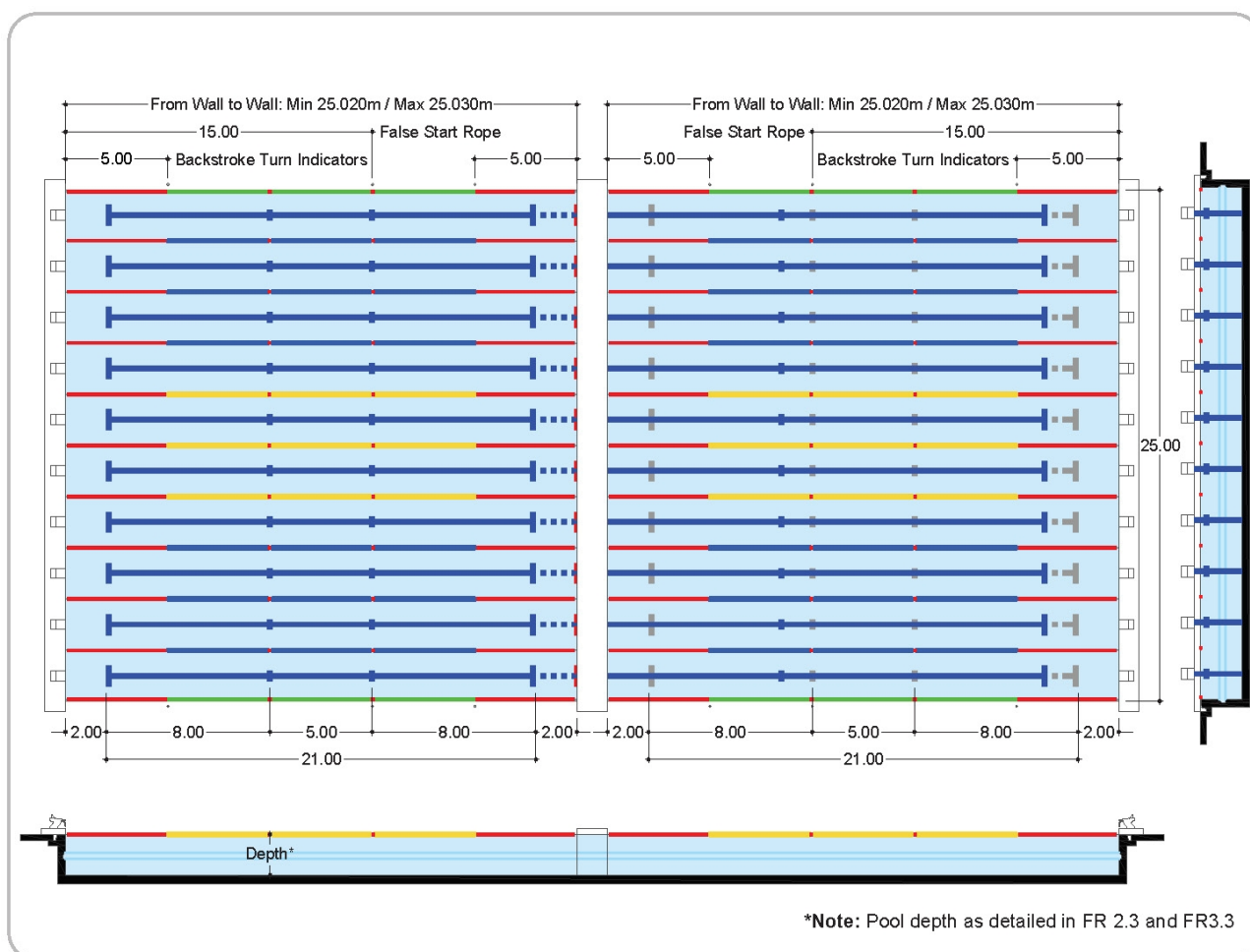
- Two (2) GREEN ropes for lanes 0 and 9.
- Six (6) BLUE ropes for lanes 1, 2, 3, 6, 7 and 8.
- Three (3) YELLOW ropes for lanes 4, 5.

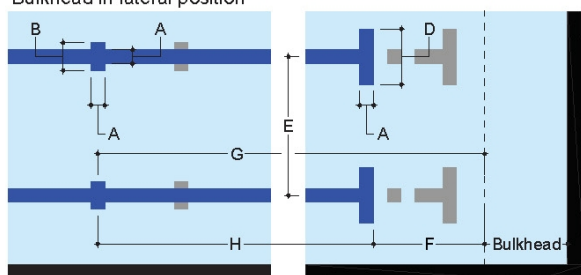

Bulkhead in lateral position

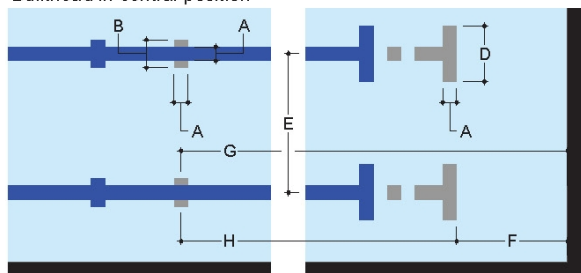

Bulkhead in central position

**Lane Markings**

Width of lane markings, end, lines targets	A	0.25m ± 0.05m
Length of end wall targets	B	0.50m
Depth to centre of end wall targets	C	0.30m
Length of lane marker cross line	D	1.00m
Width of racing lanes	E	2.50m
Distance from end of lane line to end wall	F	2.00m*
Distance from centre of cross line to end wall	G	15.00m*
Distance from end of lane line to centre of cross line	H	13.00m
Distance from centre of cross line to end wall	I	25.00m*

* Pool tolerance has to be considered

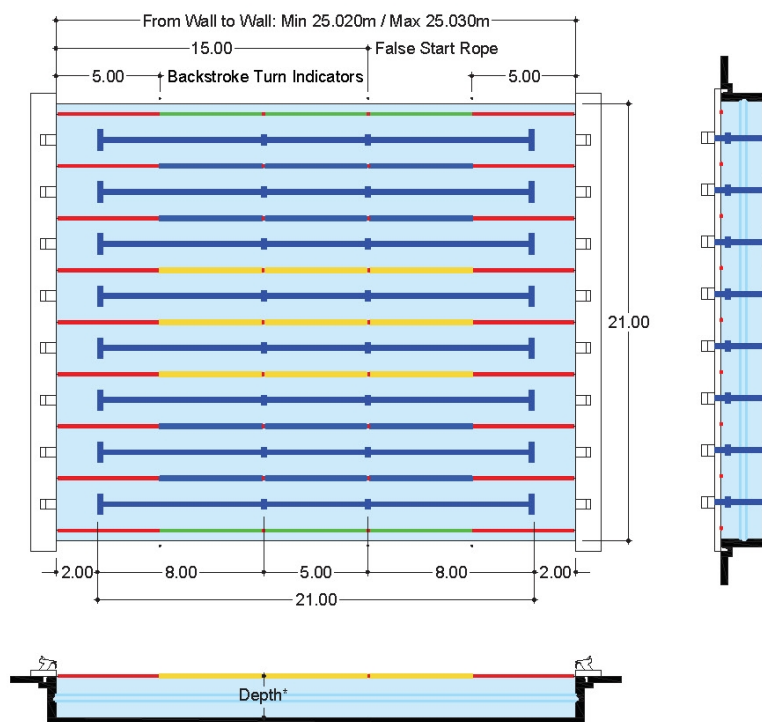

*Note: Pool depth as detailed in FR 2.3 and FR3.3

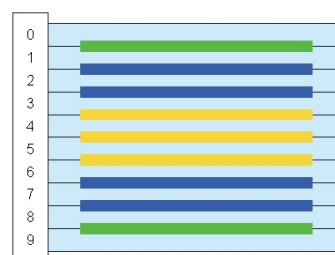
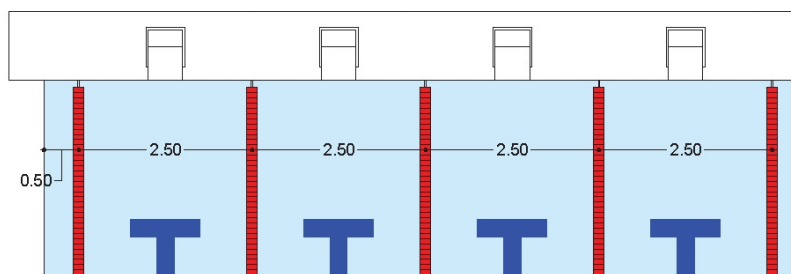
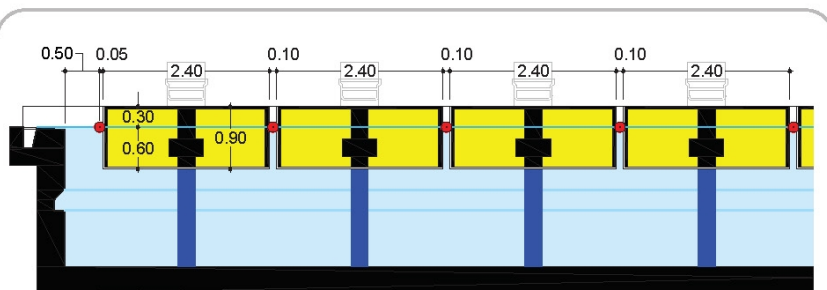

Lane Ropes

In a 8 (eight) lanes swimming pool the colour of the lane ropes should be as follows:

- Two (2) GREEN ropes for lanes 1 and 8.
- Four (4) BLUE ropes for lanes 2, 3, 6 and 7.
- Three (3) YELLOW ropes for lanes 4, 5.

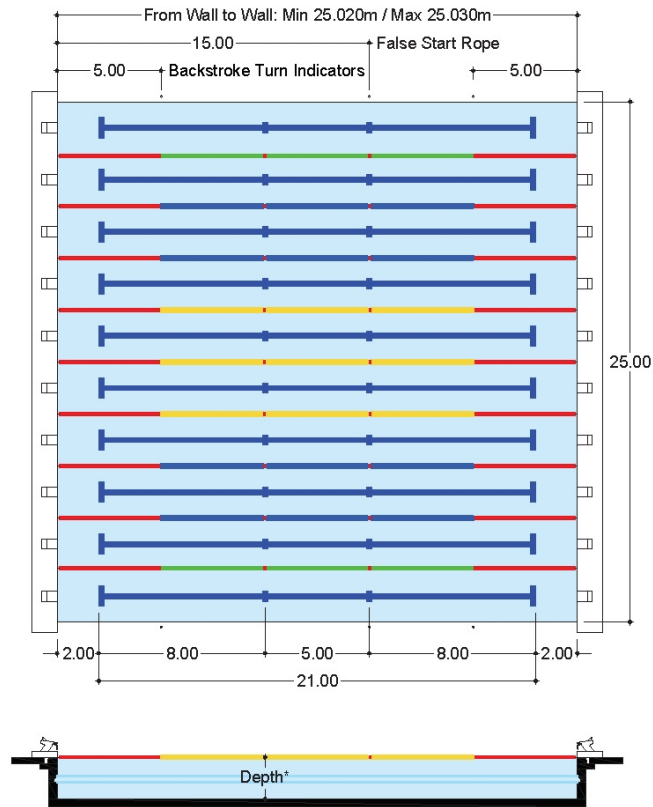

*Note: Pool depth as detailed in FR 2.3 and FR3.3

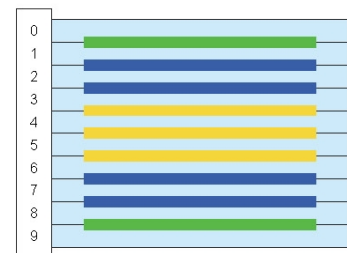
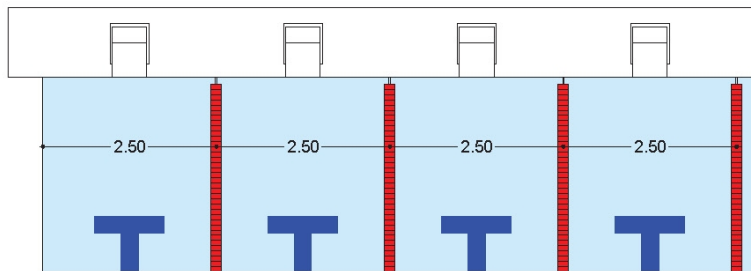
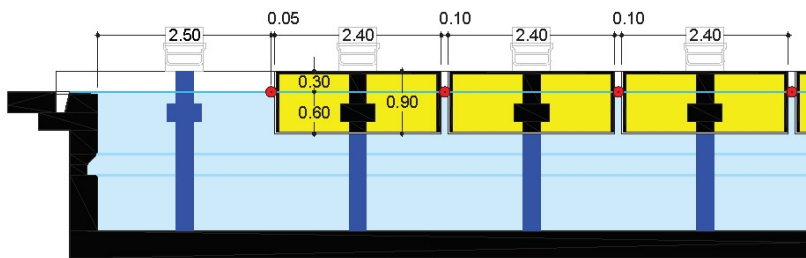

Lane Ropes

In a 8 (eight) lanes swimming pool the colour of the lane ropes should be as follows:

- Two (2) GREEN ropes for lanes 1 and 8.
- Four (4) BLUE ropes for lanes 2, 3, 6 and 7.
- Three (3) YELLOW ropes for lanes 4, 5.

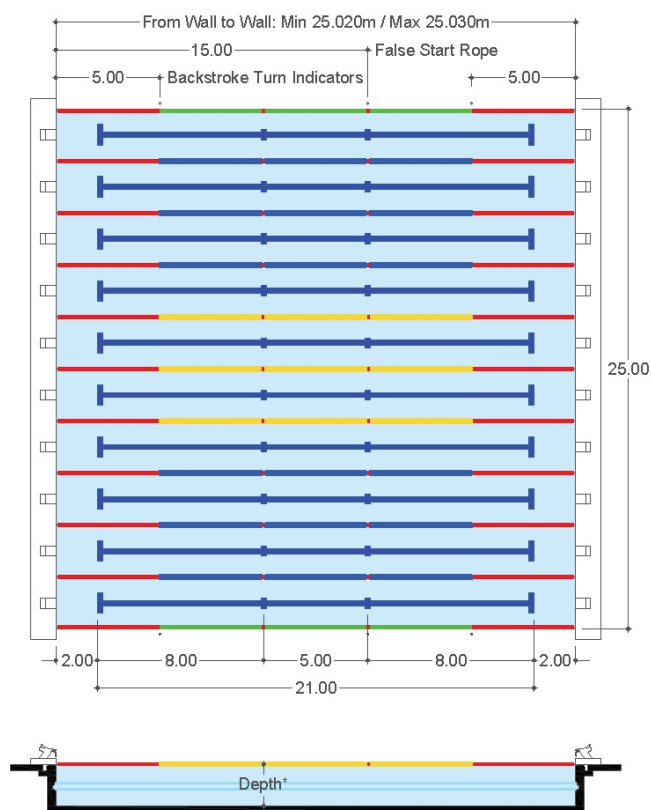

*Note: Pool depth as detailed in FR 2.3 and FR3.3

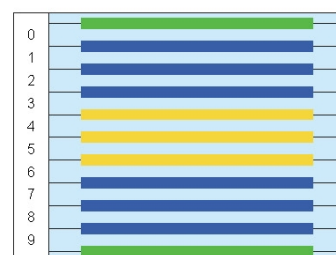
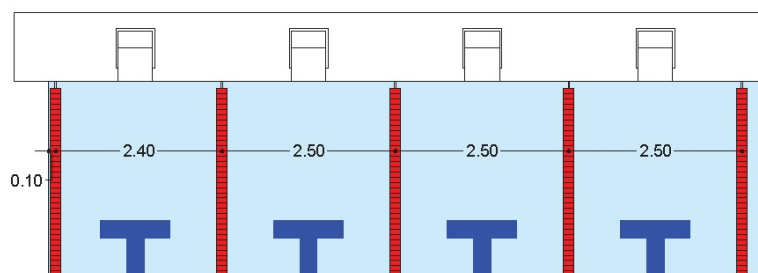
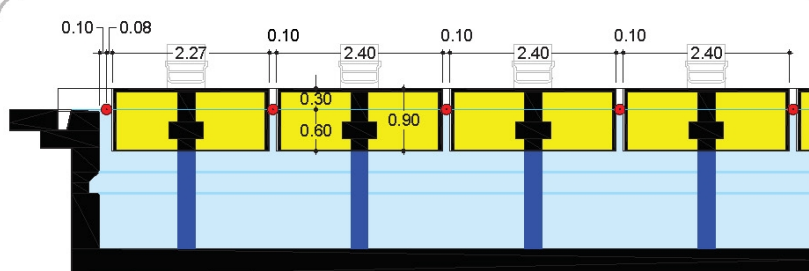

Lane Ropes

In a 10 (ten) lanes swimming pool the colour of the lane ropes should be as follows:

- Two (2) GREEN ropes for lanes 0 and 9.
- Six (6) BLUE ropes for lanes 1, 2, 3, 6, 7 and 8.
- Three (3) YELLOW ropes for lanes 4, 5.

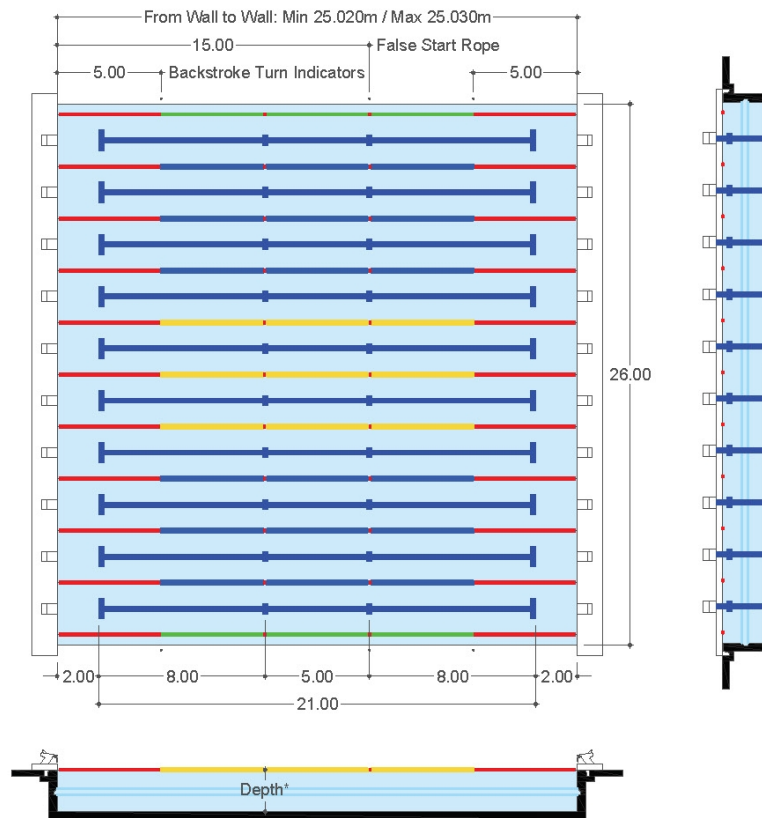

*Note: Pool depth as detailed in FR 2.3 and FR3.3

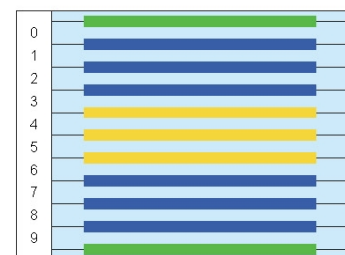
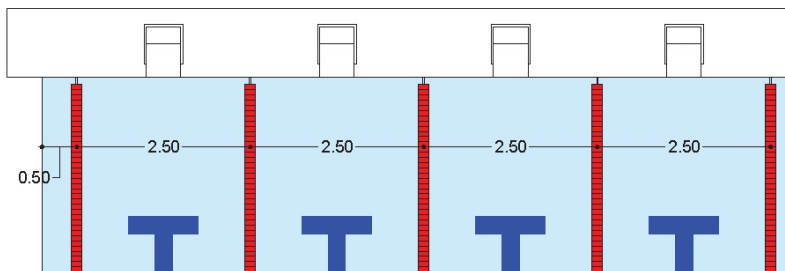
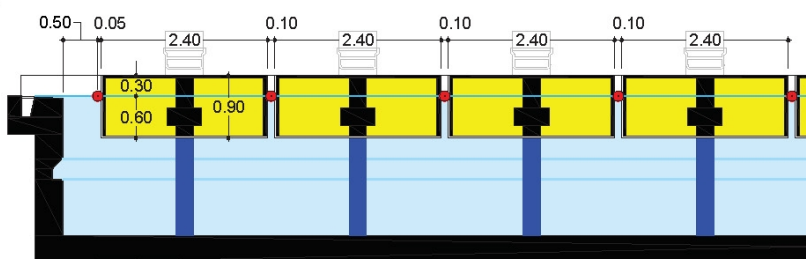

Lane Ropes

In a 10 (ten) lanes swimming pool the colour of the lane ropes should be as follows:

- Two (2) GREEN ropes for lanes 0 and 9.
- Six (6) BLUE ropes for lanes 1, 2, 3, 6, 7 and 8.
- Three (3) YELLOW ropes for lanes 4, 5.

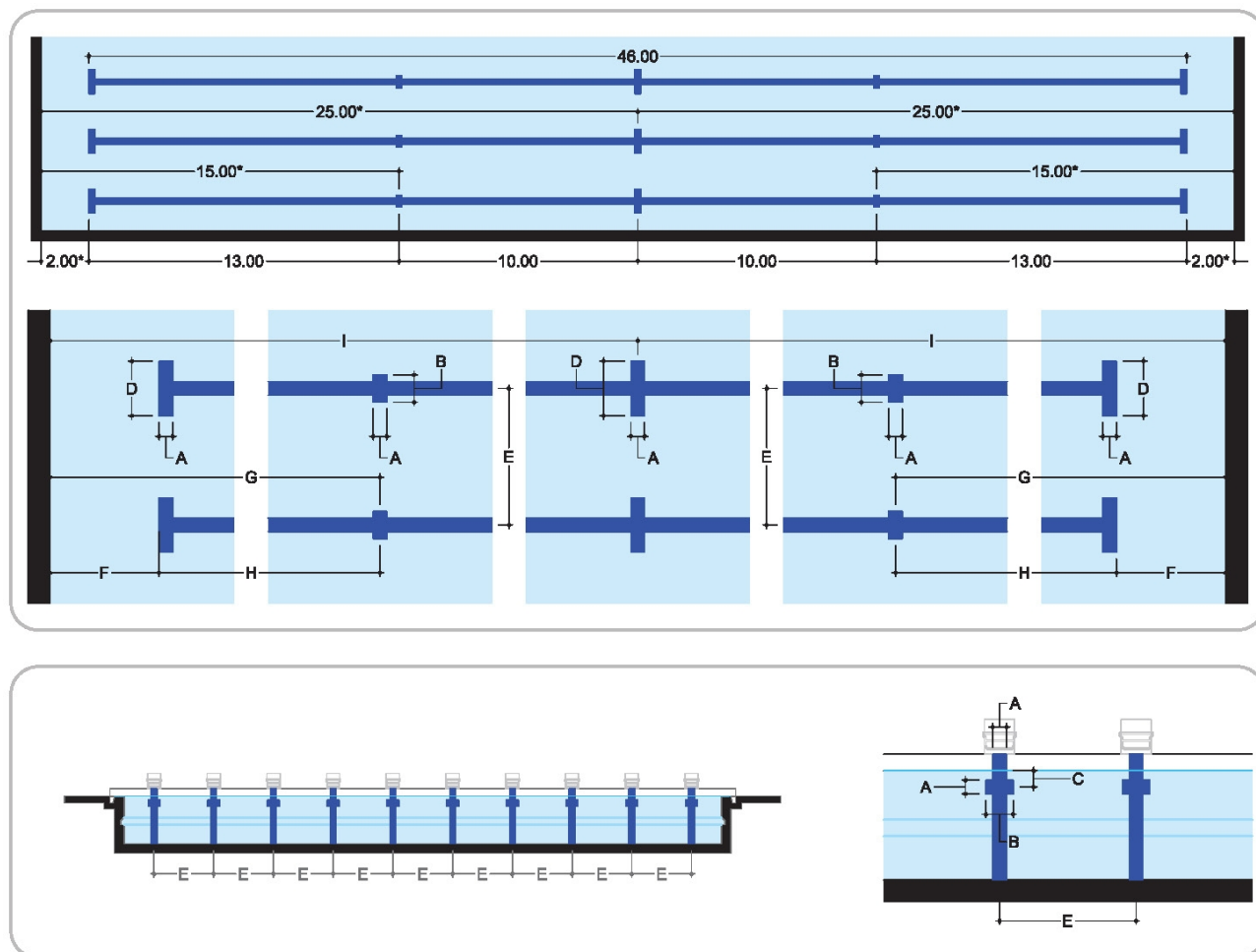

Lane Markings

Width of lane markings, end, lines targets	A	0.25m ± 0.05m
Length of end wall targets	B	0.50m
Depth to centre of end wall targets	C	0.30m
Length of lane marker cross line	D	1.00m
Width of racing lanes	E	2.50m
Distance from end of lane line to end wall	F*	2.00m*
Distance from centre of cross line to end wall	G	15.00m*
Distance from end of lane line to centre of cross line	H	13.00m
Distance from centre of cross line to end wall	I	25.00m*

* Pool tolerance has to be considered

**18 APPENDICES**

- 18.1 APPENDIX 1 - DIAGRAM SWIMMING POOL 50x25m – 8 Lane
- 18.2 APPENDIX 2 - DIAGRAM SWIMMING POOL 50X25m – 10 Lanes
- 18.3 APPENDIX 3 - DIAGRAM SWIMMING POOL 50X25m – 10 Lanes
- 18.4 APPENDIX 4 - DIAGRAM SWIMMING POOL 50X25 WITH ONE BULKHEAD IN LATERAL POSITION
- 18.5 APPENDIX 5 - DIAGRAM SWIMMING POOL 50X25M WITH ONE BULKHEAD –BULKHEAD IN CENTRAL POSITION
- 18.6 APPENDIX 6 - DIAGRAM SWIMMING POOL 25X21M – 8 Lanes
- 18.7 APPENDIX 7 - DIAGRAM SWIMMING POOL 25X21M – 8 Lanes
- 18.8 APPENDIX 8 - DIAGRAM SWIMMING POOL 25X25M – 10 Lanes
- 18.9 APPENDIX 9 - DIAGRAM SWIMMING POOL 25X26M – 10 Lanes
- 18.10 APPENDIX 10 - DIAGRAM 50m SWIMMING POOL – Lane markings



18.1 APPENDIX 1 - DIAGRAM SWIMMING POOL 50x25m - 8 Lane

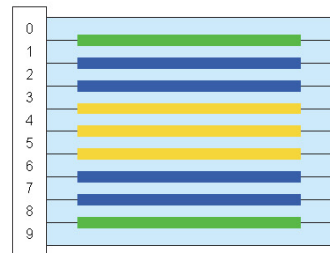
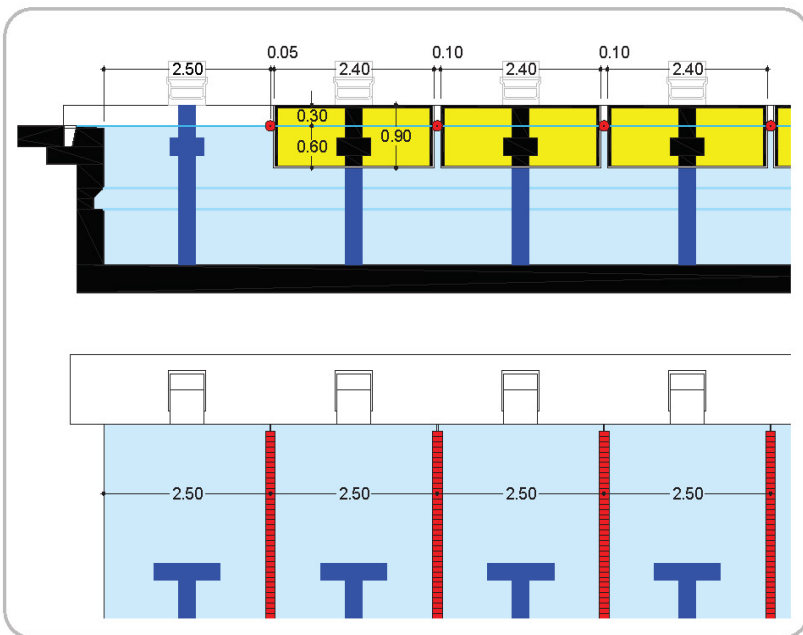
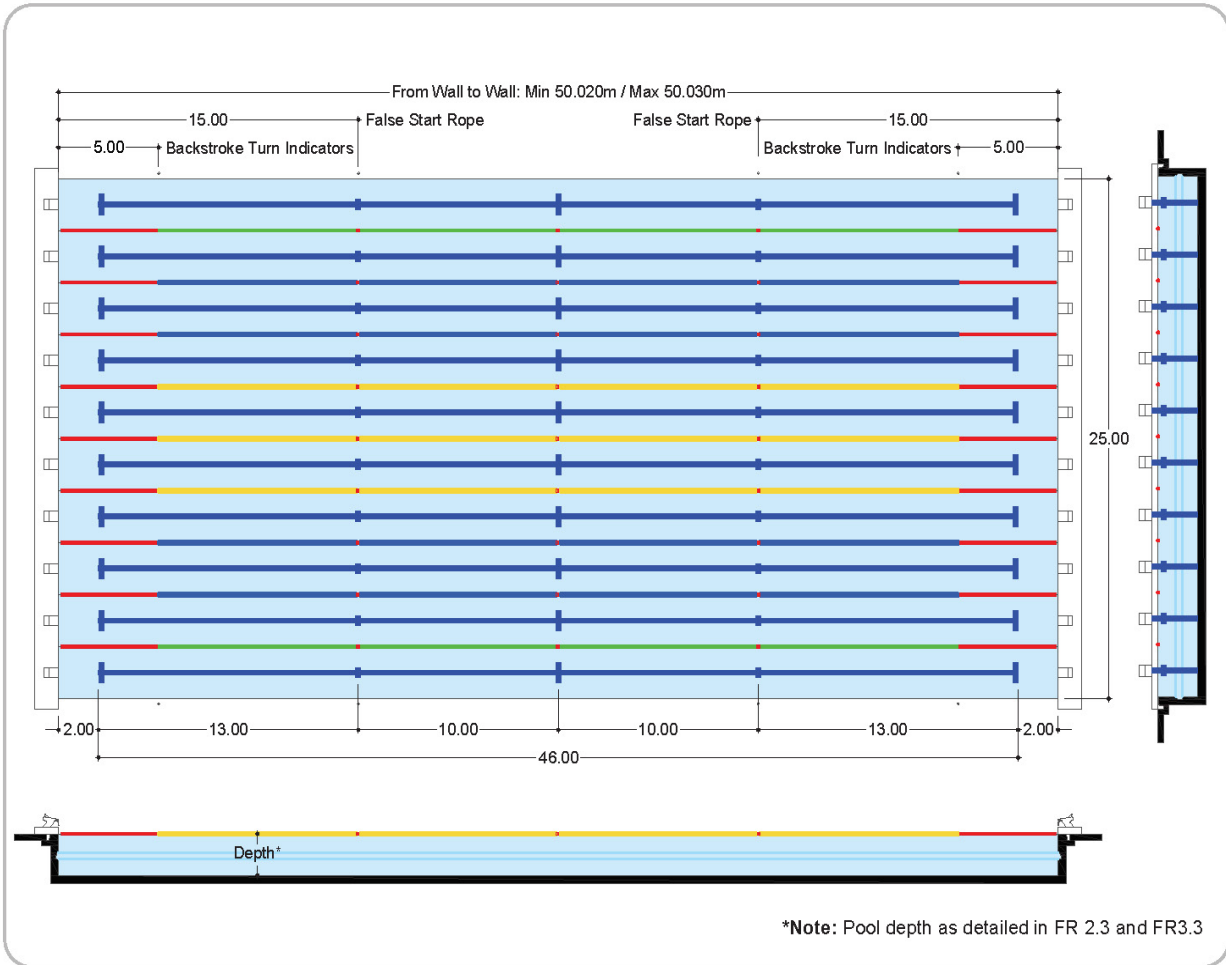

Lane Ropes

In a 8 (eight) lanes swimming pool the colour of the lane ropes should be as follows:

- Two (2) GREEN ropes for lanes 1 and 8.
- Four (4) BLUE ropes for lanes 2, 3, 6 and 7.
- Three (3) YELLOW ropes for lanes 4, 5.



18.2 APPENDIX 2 - DIAGRAM SWIMMING POOL 50X25m – 10 Lanes

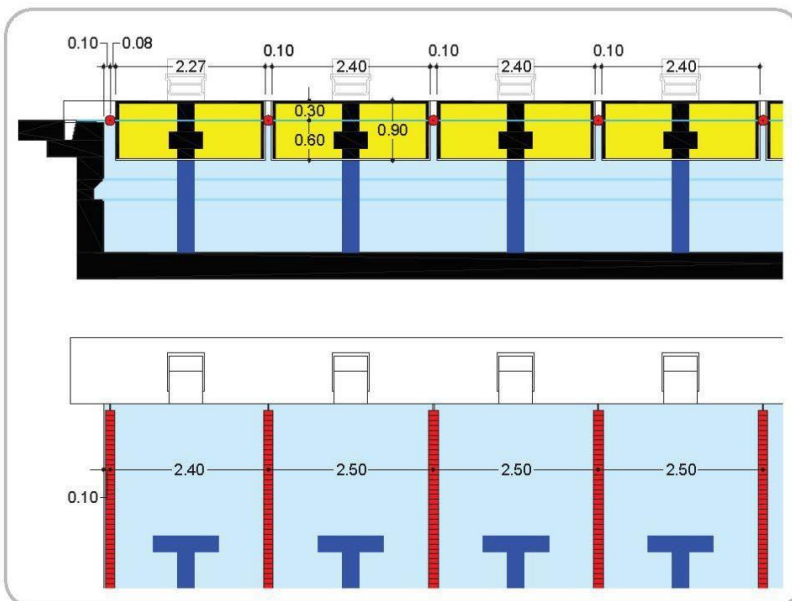
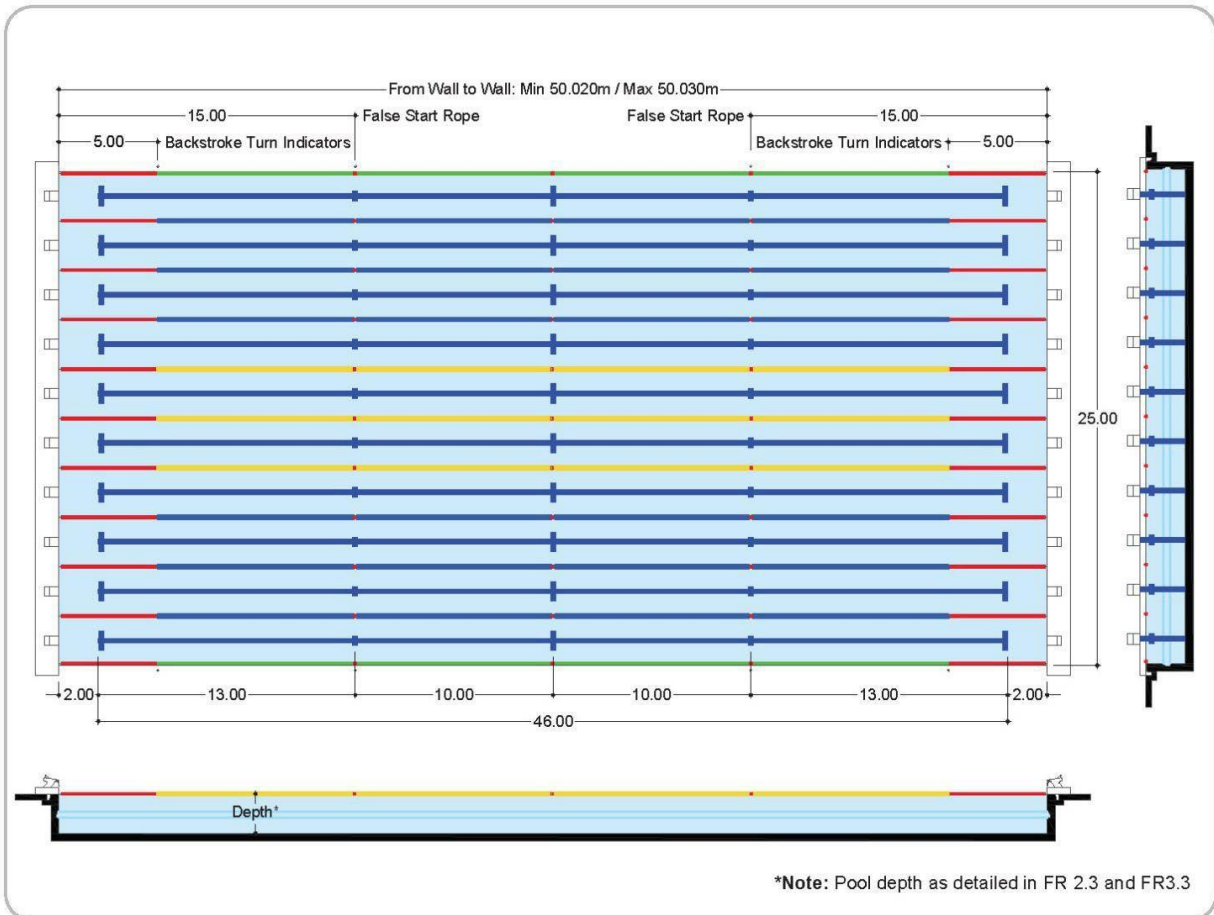

Lane Ropes

In a 10 (ten) lanes swimming pool the colour of the lane ropes should be as follows:

- Two (2) GREEN ropes for lanes 0 and 9.
- Six (6) BLUE ropes for lanes 1, 2, 3, 6, 7 and 8.
- Three (3) YELLOW ropes for lanes 4, 5.



18.3 APPENDIX 3 - DIAGRAM SWIMMING POOL 50X25m – 10 Lanes

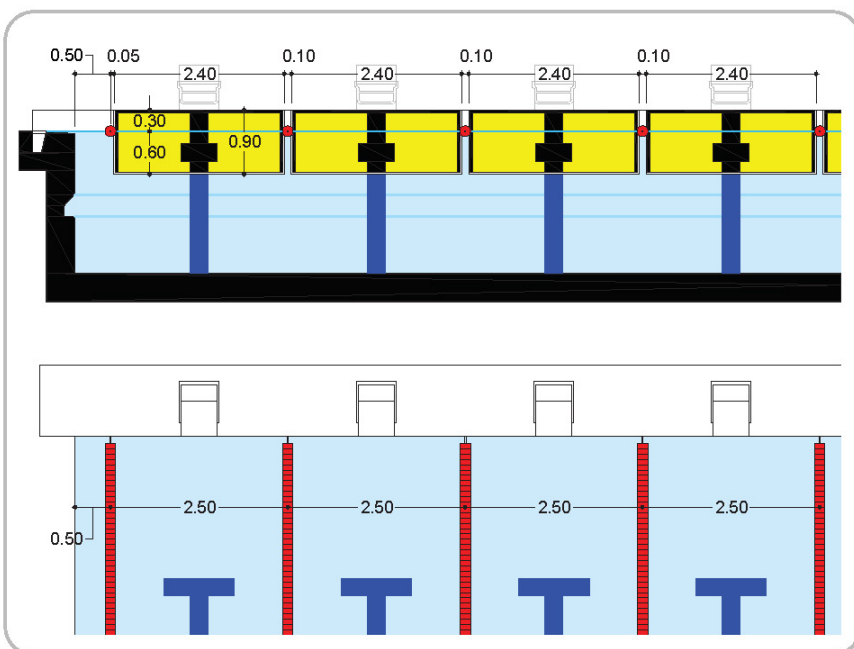
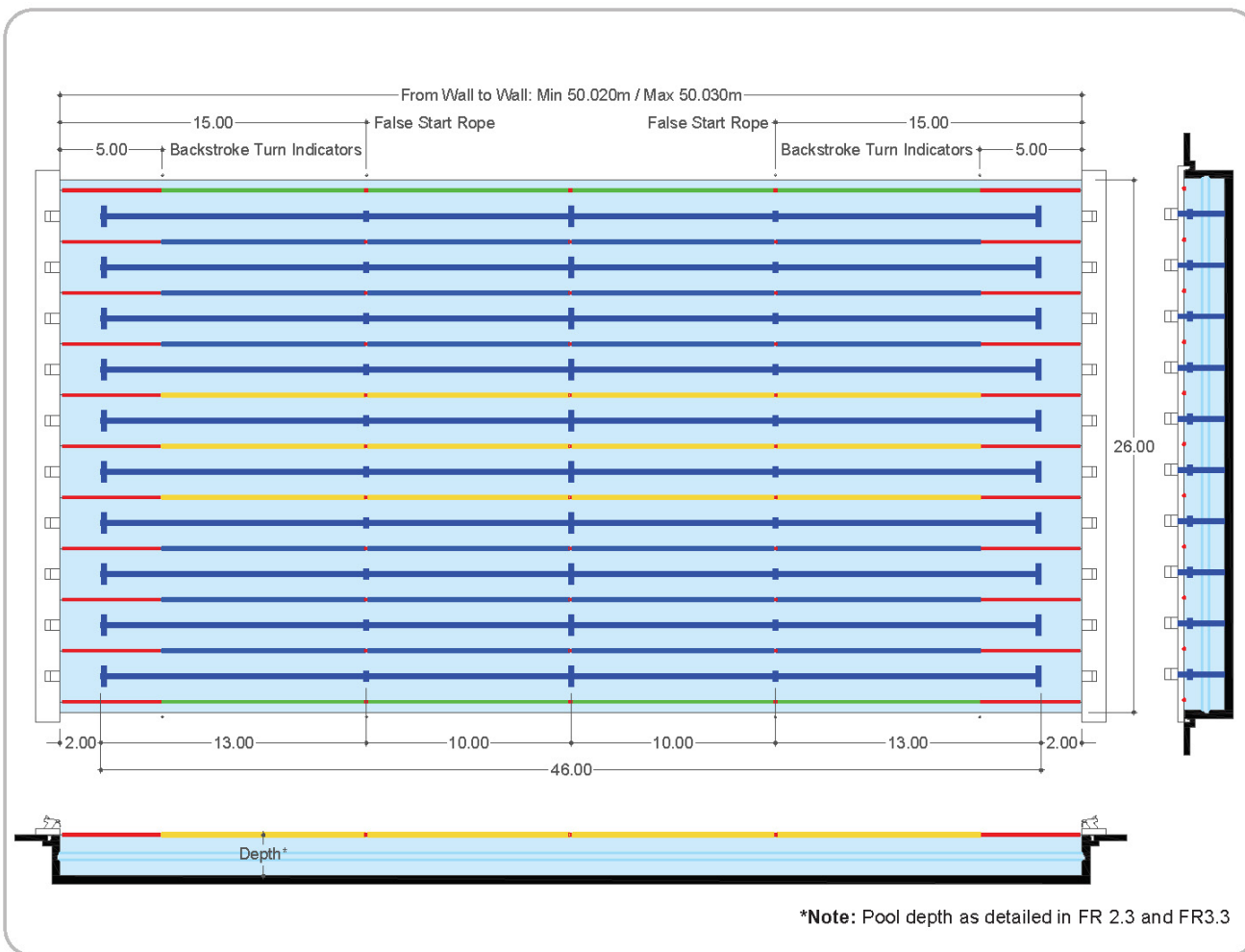

Lane Ropes

In a 10 (ten) lanes swimming pool the colour of the lane ropes should be as follows:

- Two (2) GREEN ropes for lanes 0 and 9.
- Six (6) BLUE ropes for lanes 1, 2, 3, 6, 7 and 8.
- Three (3) YELLOW ropes for lanes 4, 5.



18.4 APPENDIX 4 - DIAGRAM SWIMMING POOL 50X25 WITH ONE BULKHEAD IN LATERAL POSITION

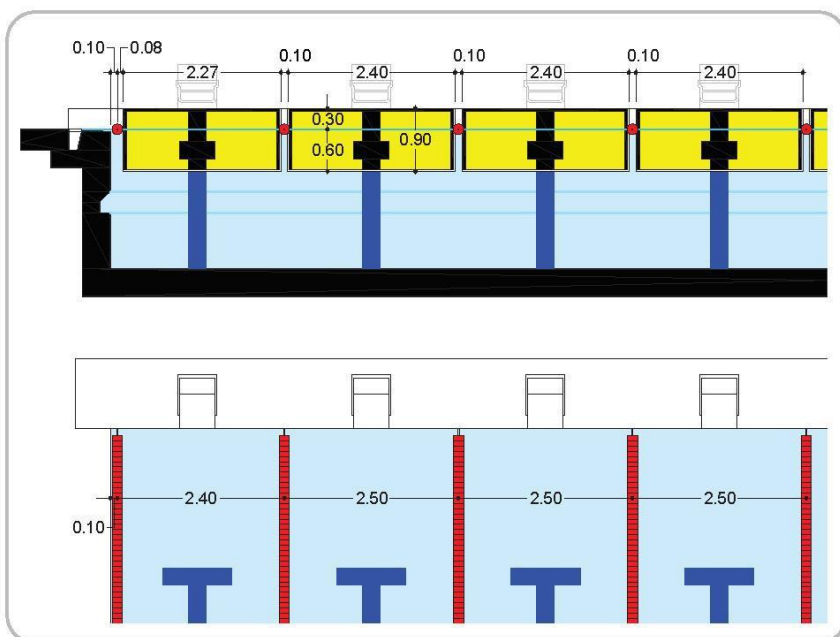
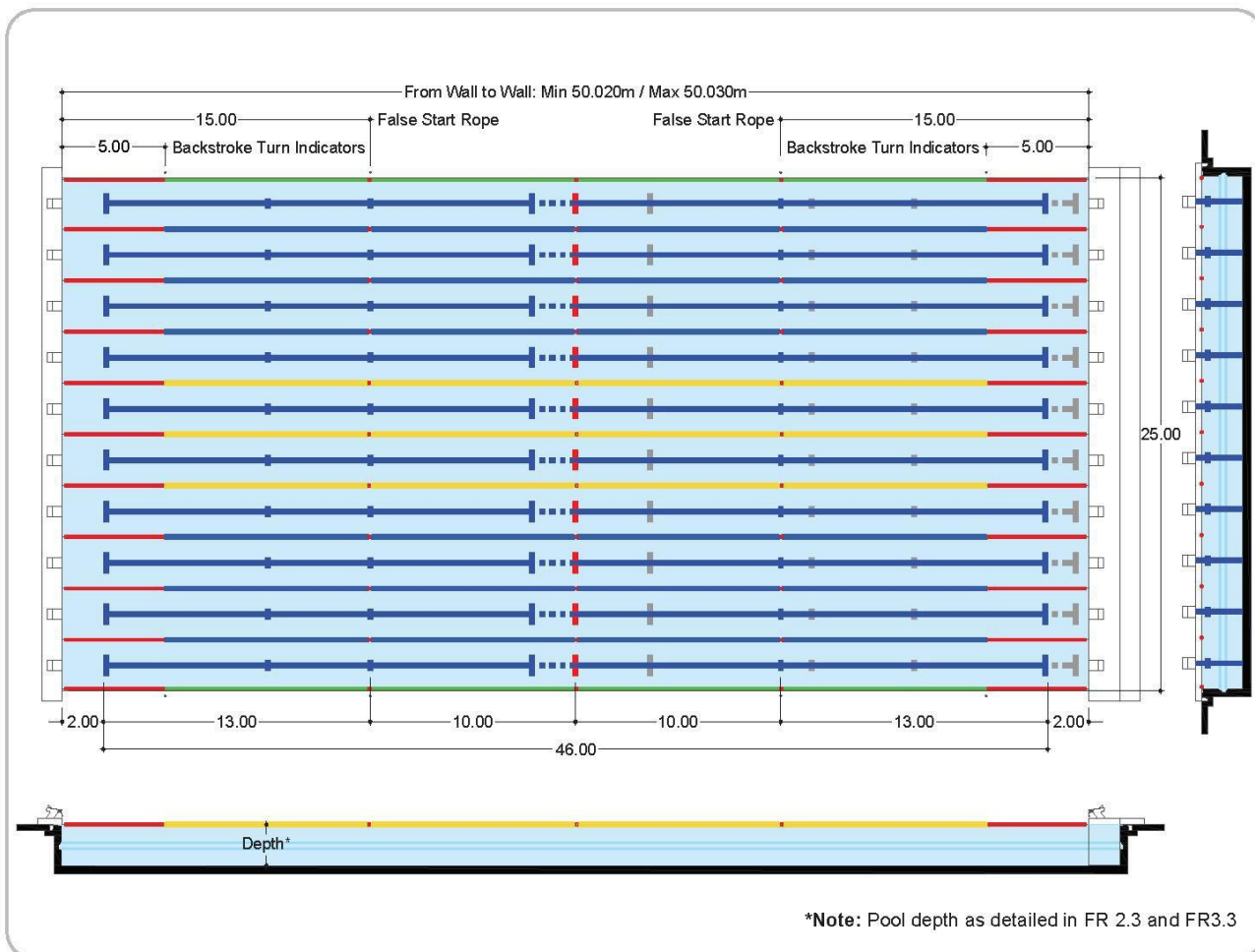

Lane Ropes

In a 10 (ten) lanes swimming pool the colour of the lane ropes should be as follows:

- Two (2) GREEN ropes for lanes 0 and 9.
- Six (6) BLUE ropes for lanes 1, 2, 3, 6, 7 and 8.
- Three (3) YELLOW ropes for lanes 4, 5.



18.5 APPENDIX 5 – DIAGRAM SWIMMING POOL 50X25M WITH ONE BULKHEAD – BULKHEAD IN CENTRAL POSITION

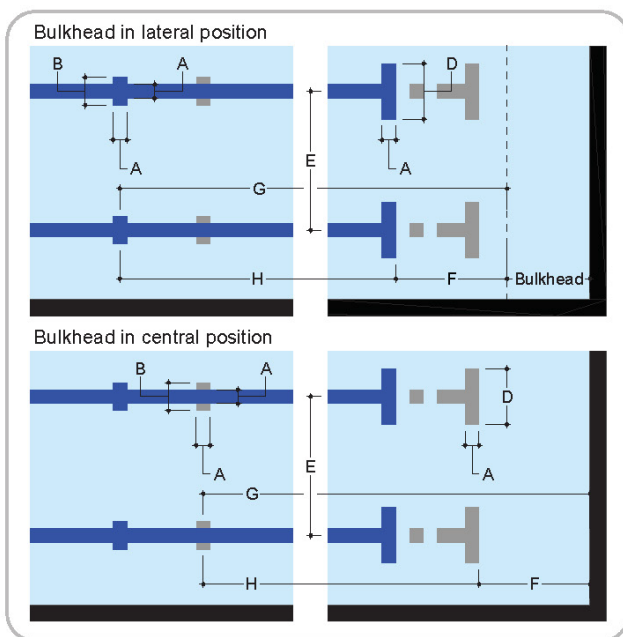
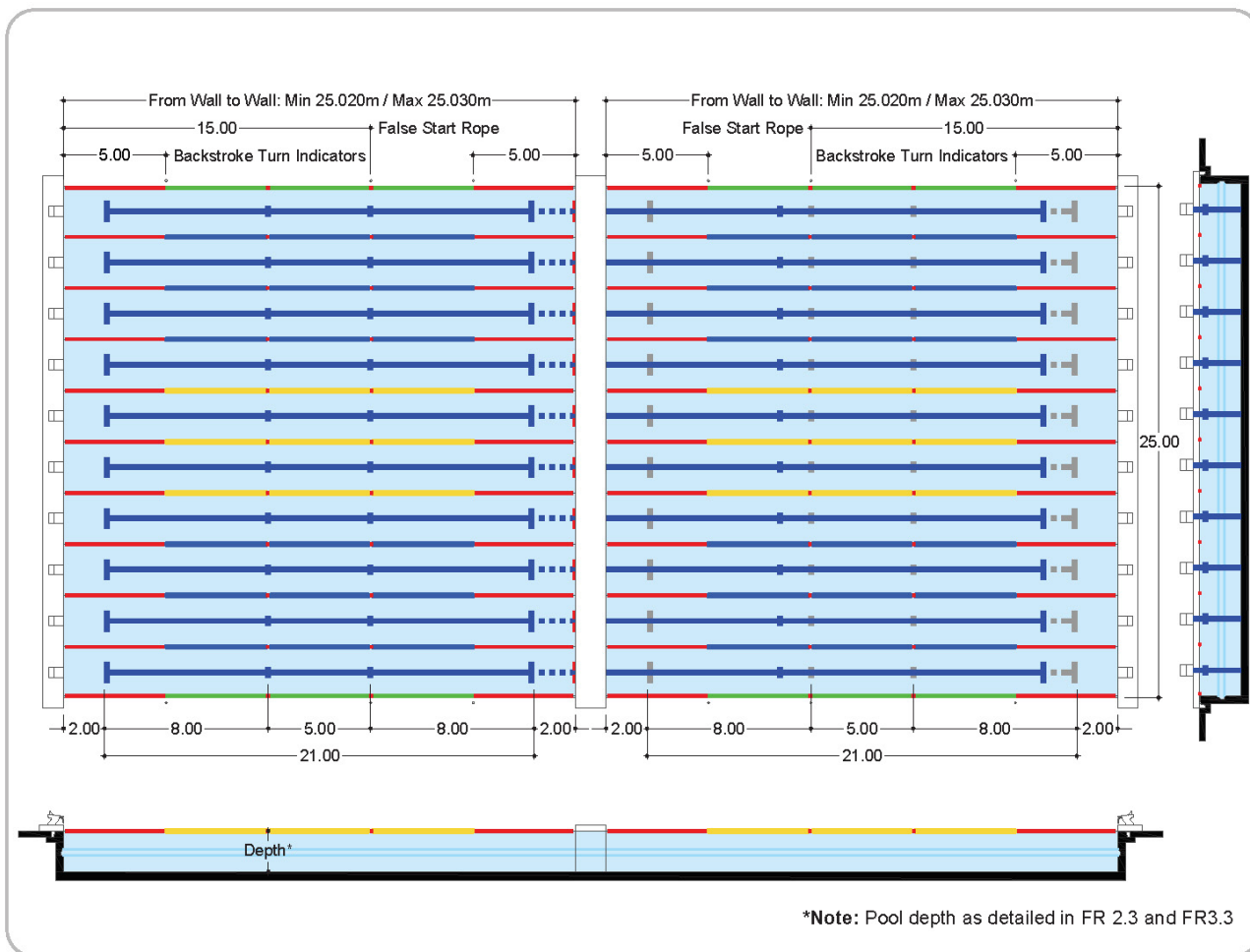

Lane Markings

Width of lane markings, end, lines targets	A	0.25m ± 0.05m
Length of end wall targets	B	0.50m
Depth to centre of end wall targets	C	0.30m
Length of lane marker cross line	D	1.00m
Width of racing lanes	E	2.50m
Distance from end of lane line to end wall	F	2.00m*
Distance from centre of cross line to end wall	G	15.00m*
Distance from end of lane line to centre of cross line	H	13.00m
Distance from centre of cross line to end wall	I	25.00m*

** Pool tolerance has to be considered*



18.6 APPENDIX 6 - DIAGRAM SWIMMING POOL 25X21M – 8 Lanes

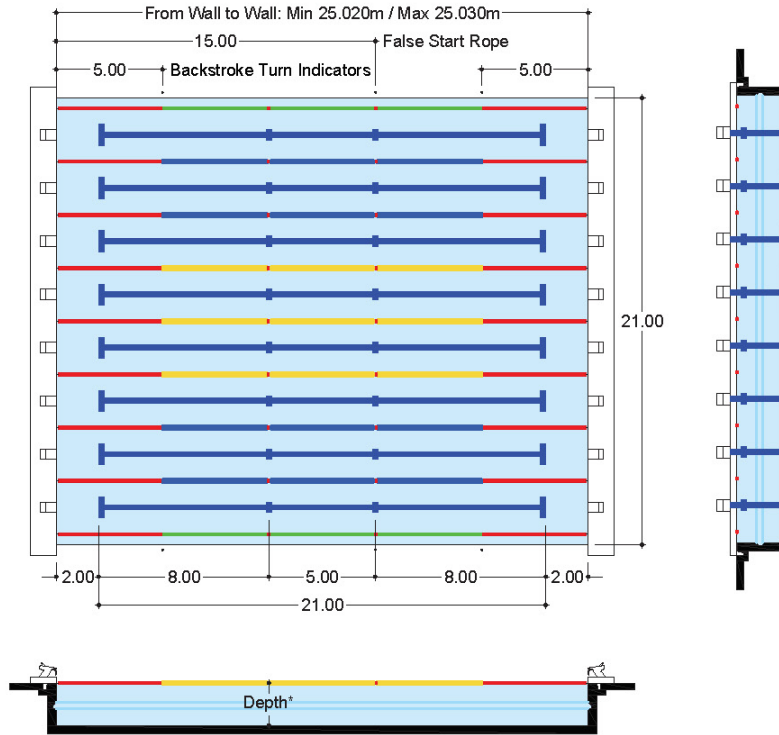

*Note: Pool depth as detailed in FR 2.3 and FR3.3

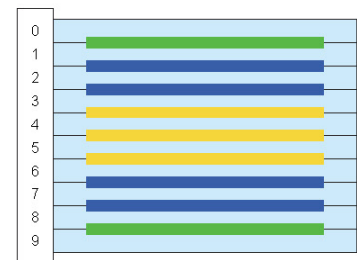
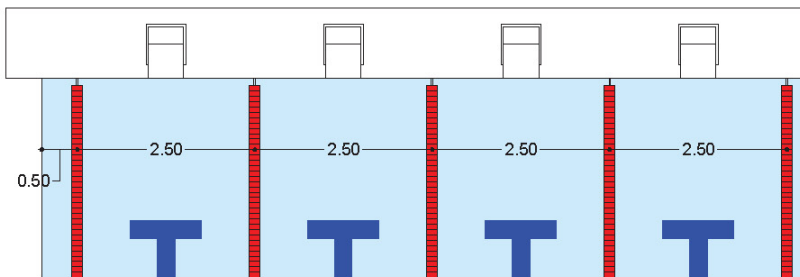
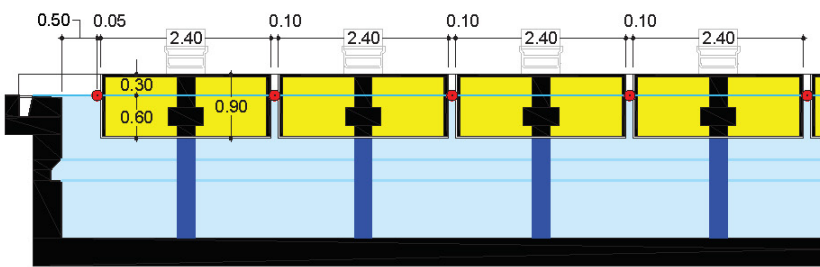

Lane Ropes

In a 8 (eight) lanes swimming pool the colour of the lane ropes should be as follows:

- Two (2) GREEN ropes for lanes 1 and 8.
- Four (4) BLUE ropes for lanes 2, 3, 6 and 7.
- Three (3) YELLOW ropes for lanes 4, 5.



18.7 APPENDIX 7 - DIAGRAM SWIMMING POOL 25X21M – 8 Lanes

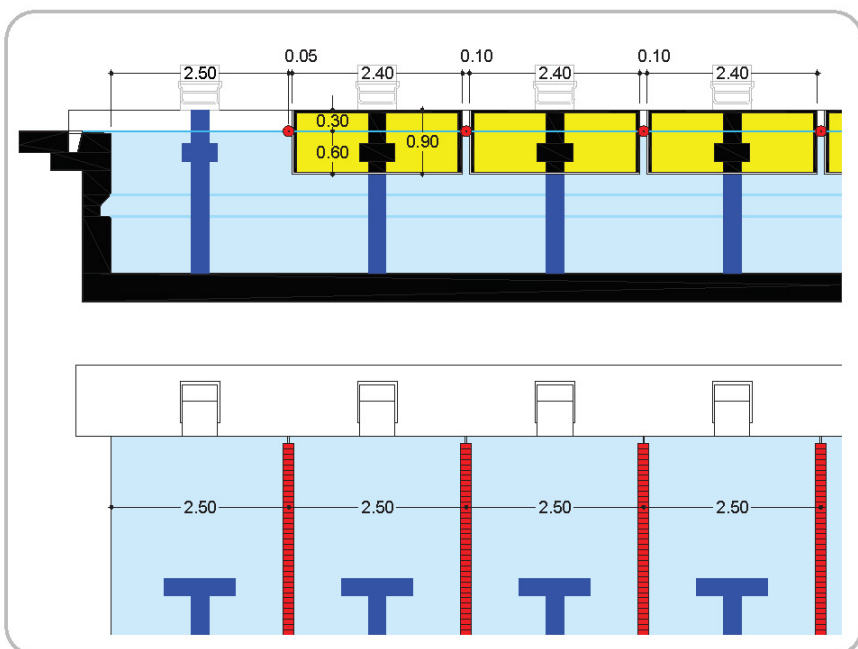
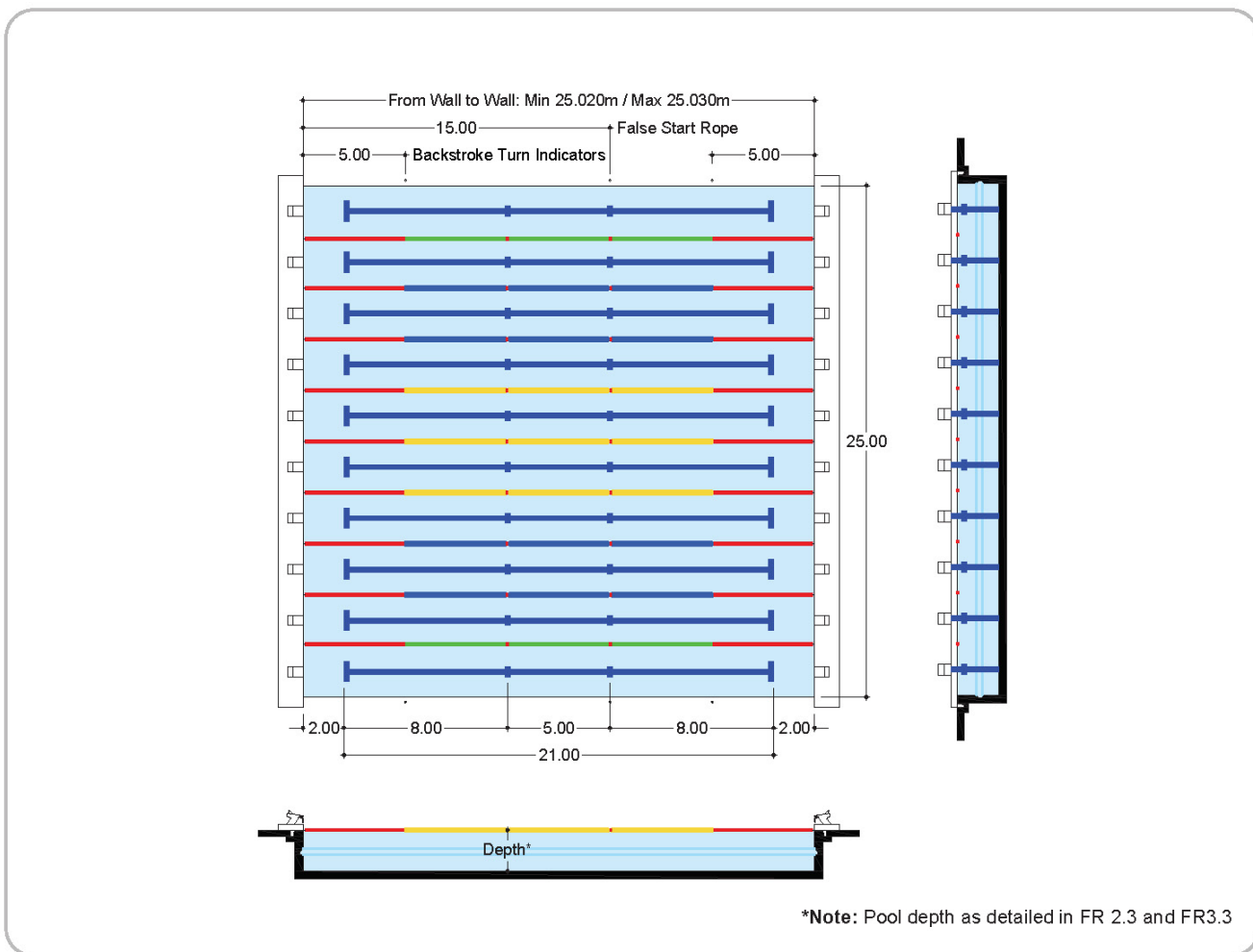

Lane Ropes

In a 8 (eight) lanes swimming pool the colour of the lane ropes should be as follows:

- Two (2) GREEN ropes for lanes 1 and 8.
- Four (4) BLUE ropes for lanes 2, 3, 6 and 7.
- Three (3) YELLOW ropes for lanes 4, 5.



18.8 APPENDIX 8 - DIAGRAM SWIMMING POOL 25X25M – 10 Lanes

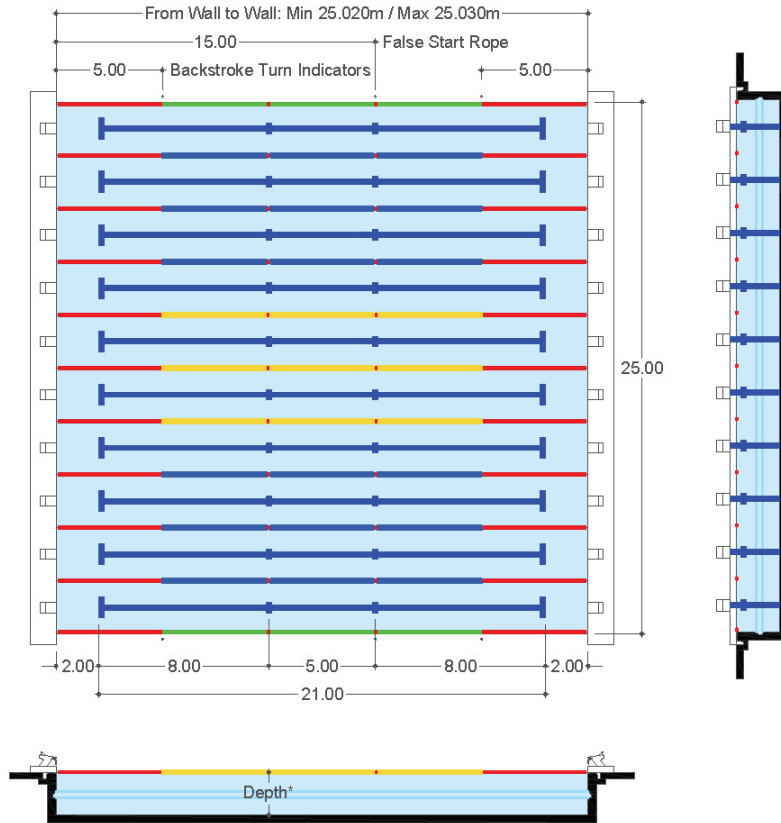

*Note: Pool depth as detailed in FR 2.3 and FR3.3

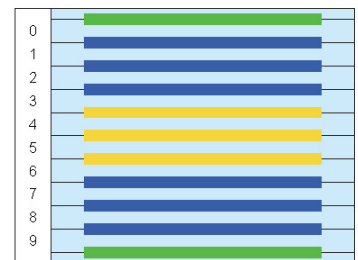
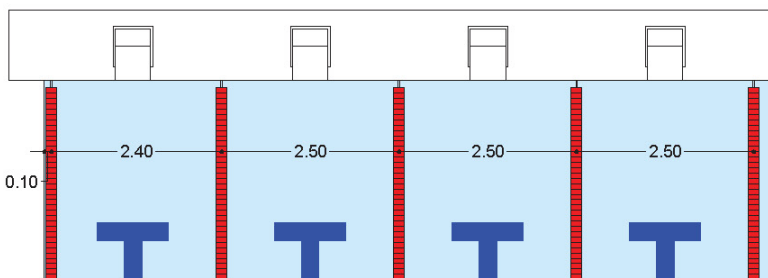
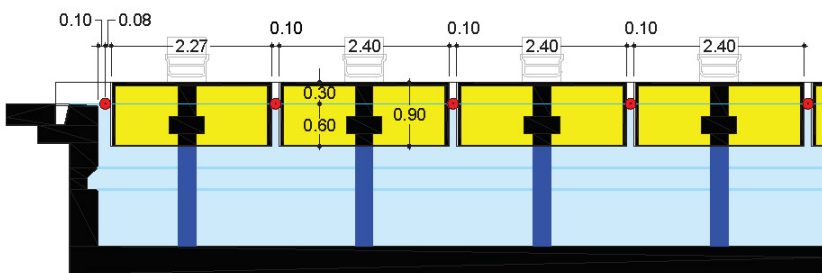

Lane Ropes

In a 10 (ten) lanes swimming pool the colour of the lane ropes should be as follows:

- Two (2) GREEN ropes for lanes 0 and 9.
- Six (6) BLUE ropes for lanes 1, 2, 3, 6, 7 and 8.
- Three (3) YELLOW ropes for lanes 4, 5.

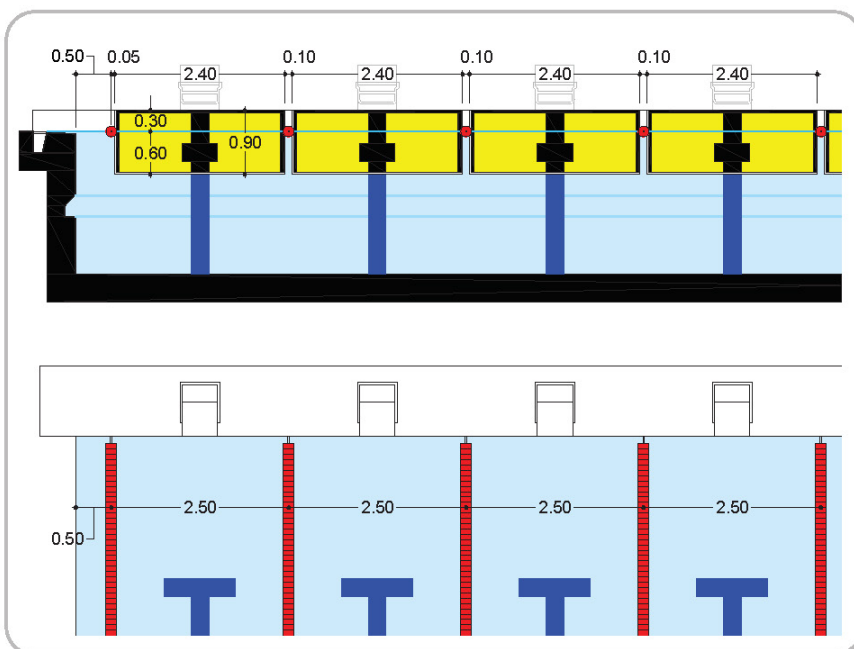
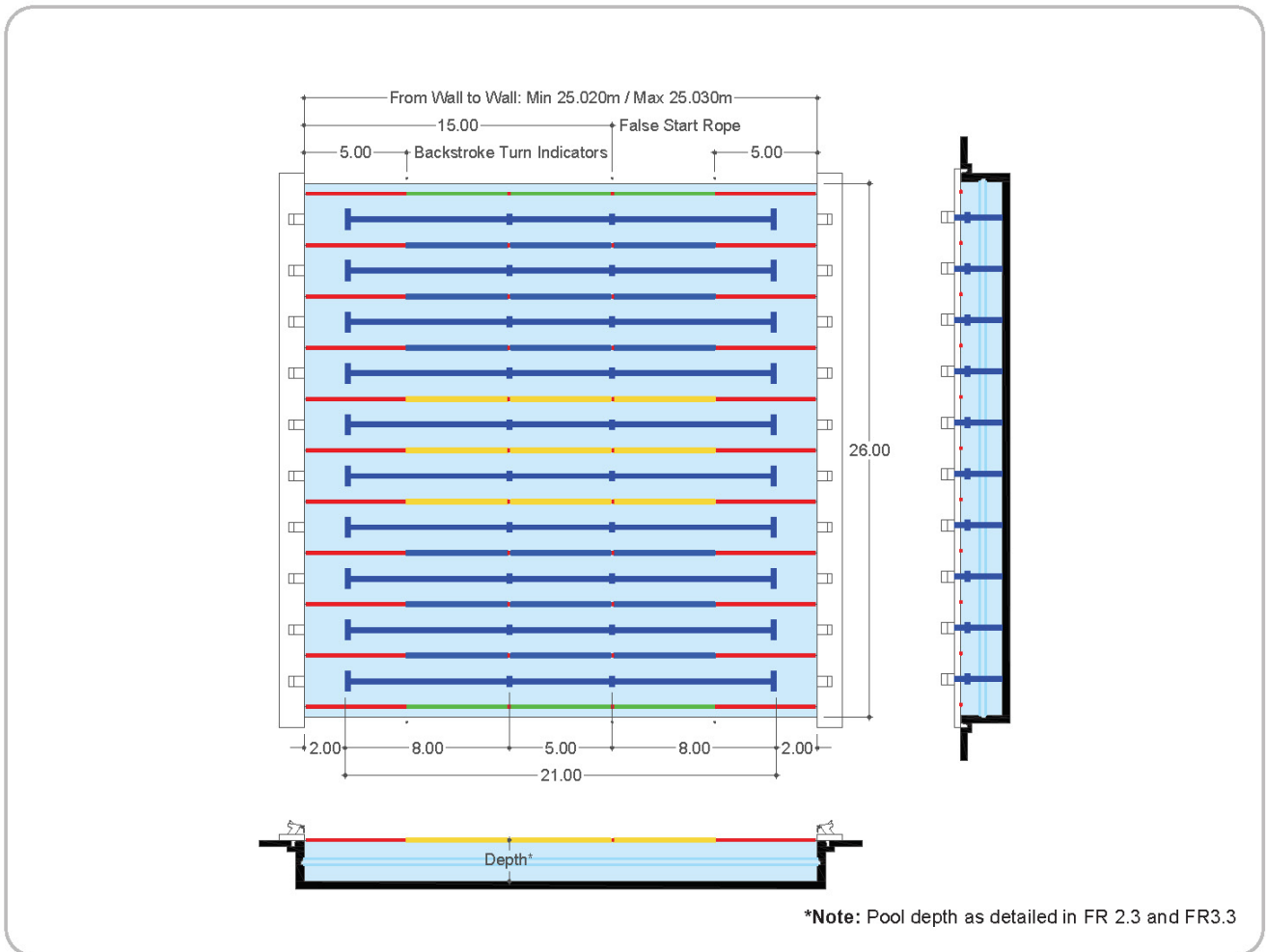
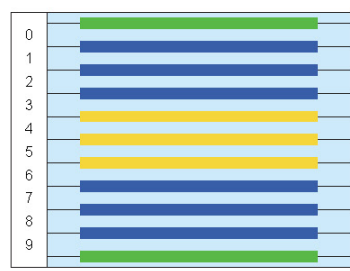

18.9 APPENDIX 9 - DIAGRAM SWIMMING POOL 25X26M – 10 Lanes

Lane Ropes

In a 10 (ten) lanes swimming pool the colour of the lane ropes should be as follows:

- Two (2) GREEN ropes for lanes 0 and 9.
- Six (6) BLUE ropes for lanes 1, 2, 3, 6, 7 and 8.
- Three (3) YELLOW ropes for lanes 4, 5.

18.10 APPENDIX 10 - DIAGRAM 50m SWIMMING POOL – Lane markings

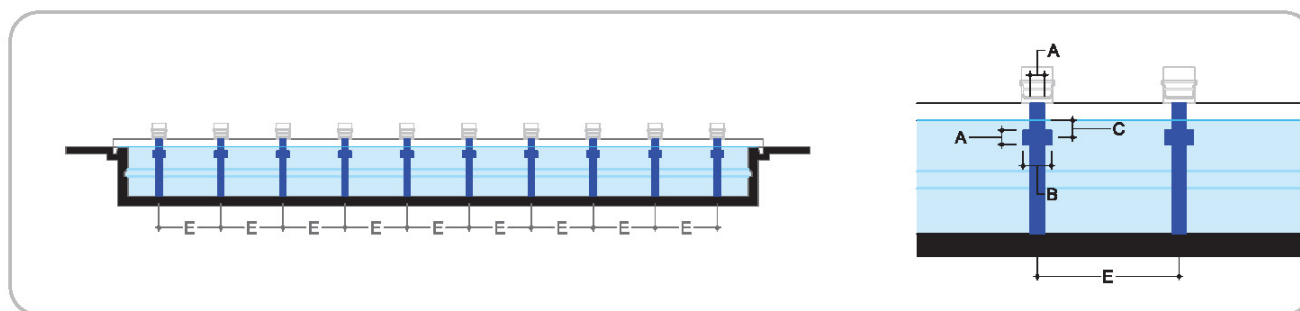
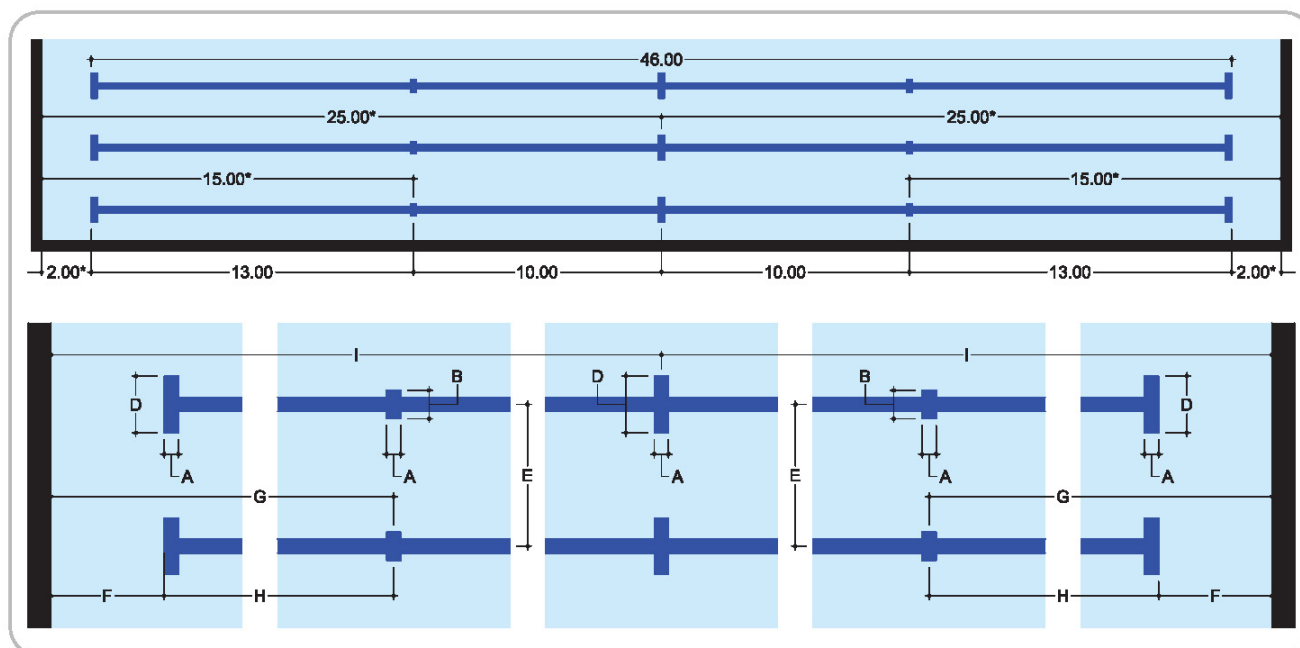
Lane Markings

Width of lane markings, end, lines targets	A	0.25m ± 0.05m
Length of end wall targets	B	0.50m
Depth to centre of end wall targets	C	0.30m
Length of lane marker cross line	D	1.00m
Width of racing lanes	E	2.50m
Distance from end of lane line to end wall	F*	2.00m*
Distance from centre of cross line to end wall	G	15.00m*
Distance from end of lane line to centre of cross line	H	13.00m
Distance from centre of cross line to end wall	I	25.00m*

* Pool tolerance has to be considered